

Brick slip lintels

B section range 290 mm high

Section at span:

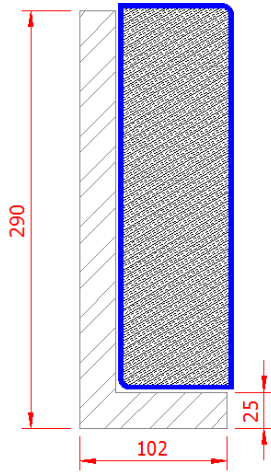

Section at bearing :

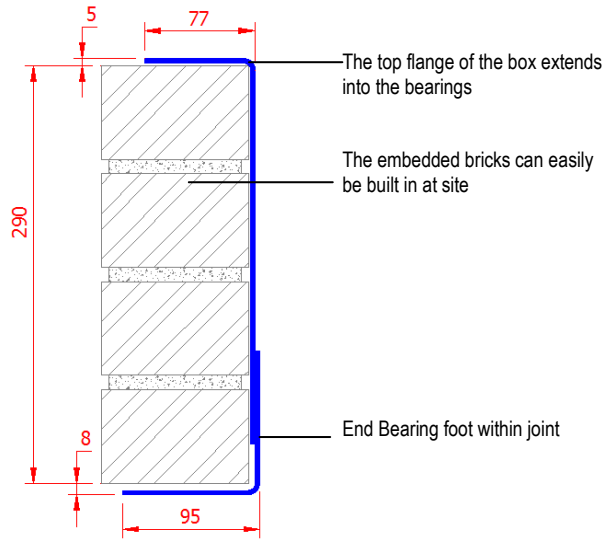

B290/3

Lintel section properties

Ixx	1711.9 cm ⁴
Zxx	127.8 cm ³
Weight	16.3 kg/m
Area	20.4 cm
Ryy	3.5 cm

B290/4

Lintel section properties

Ixx	2279.8 cm ⁴
Zxx	169.5 cm ³
Weight	21.7 kg/m
Area	27.1 cm
Ryy	3.5 cm

B290/6

Lintel section properties

Ixx	3411.8 cm ⁴
Zxx	251.7 cm ³
Weight	32.5 kg/m
Area	40.6 cm
Ryy	3.6 cm

Lintel load Capacity Table

Opening Span	Lintel Length	Safe Load kN	Load Example
600	900	99.4	
900	1200	99.4	
1200	1500	99.4	
1500	1800	99.4	
1800	2100	99.4	
2100	2400	84.3	
2400	2700	72.8	
2700	3000	63.9	
3000	3300	56.8	
3300	3600	51.0	
3600	3900	46.2	
3900	4200	42.1	Full height masonry
4200	4500	38.1	
4500	4800	33.2	
4800	5100	29.2	1500 mm masonry
5100	5400	25.8	
5400	5700	23.0	
5700	6000	20.7	

Lintel load Capacity Table

Opening Span	Lintel Length	Safe Load kN	Load Example
600	900	131.83	
900	1200	131.83	
1200	1500	131.83	
1500	1800	131.83	
1800	2100	131.83	
2100	2400	111.85	
2400	2700	96.65	
2700	3000	84.85	
3000	3300	75.44	
3300	3600	67.75	
3600	3900	61.34	
3900	4200	55.93	
4200	4500	50.73	
4500	4800	44.19	Full height masonry
4800	5100	38.84	1500 mm masonry
5100	5400	34.41	
5400	5700	30.69	
5700	6000	27.54	

Lintel load Capacity Table

Opening Span	Lintel Length	Safe Load kN	Load Example
600	900	195.8	
900	1200	195.8	
1200	1500	195.8	
1500	1800	195.8	
1800	2100	195.8	
2100	2400	166.3	
2400	2700	143.7	
2700	3000	126.2	
3000	3300	112.2	
3300	3600	100.8	
3600	3900	91.3	
3900	4200	83.2	
4200	4500	75.9	
4500	4800	66.1	
4800	5100	58.1	
5100	5400	51.5	Full height masonry
5400	5700	45.9	
5700	6000	41.2	

The section provides a bearing on the top flange with a second bearing at the "foot". Full bricks are laid up to the gauged brick eliminating the need for slips on site. Default material stainless steel SS370 (EN 1.4003) also available in stainless steel LDX2101 (EN 1.4162). Loadings are shown above to assist you in your selection 102.5mm brickwork is 2.2 kN/m². Dimensions can be varied to suit imperial, other brick sizes and thicker slips